



# HYDRANTS

## Post Hydrant

### MODEL M-EXPELO

1" FREEZE RESISTANT, SANITARY  
YARD HYDRANT, HEAVY-DUTY

#### STANDARD FEATURES

Model M-EXPELO is the original sanitary yard hydrant and is designed for delivery of a high volume of potable fresh water for industrial, rapid rail, rail passenger service, power plant or other similar uses. There are no potential cross-connections between the potable water supply and any drain outlet. After being used, all potable water is held in a self-contained reservoir below the frost line. When used again, the user operates the handle and the internal piston moves downward to immediately evacuate the reservoir.

Unlike other sanitary hydrants that use a timed venturi to empty their tank, the EXPELO does not rely on the operator to run the hydrant for a specified period of time. Positive evacuation of the reservoir is assured every time. With proper installation, year-round operation without the use of heat tape is assured.

Designed to meet ASSE 1057 sanitary yard hydrant guidelines, the M-EXPELO is the choice for railroads, municipalities and industry, as well as others who want the very best in a safe, potable water hydrant.

#### SUGGESTED SPECIFICATIONS

Hydrant shall be Murdock-Super Secur model M-EXPELO. Valve shall be lever-operated and unit shall be capable of year-round use in freezing weather. Water shall be evacuated from supply riser to water reservoir when valve is shut off. Unit shall extend below grade level so that the water reservoir is positioned below frost line. All operating parts shall be accessible without removing fixture from the ground and unit shall incorporate an integral vacuum breaker and an air bypass to assure proper drainage of potable water to the reservoir.

Top, handle, base, valve body and all external castings shall be brass and finished with a heavy grade of oil-based green enamel. Outer casing shall be galvanized steel pipe. Inner supply assembly shall incorporate solid-brass castings. All solid-brass castings shall conform to ASTM standards B61 and B62. Lead-free castings shall be used in all waterways. Outlet riser pipe shall be red brass pipe. Outlet coupling shall be solid brass.

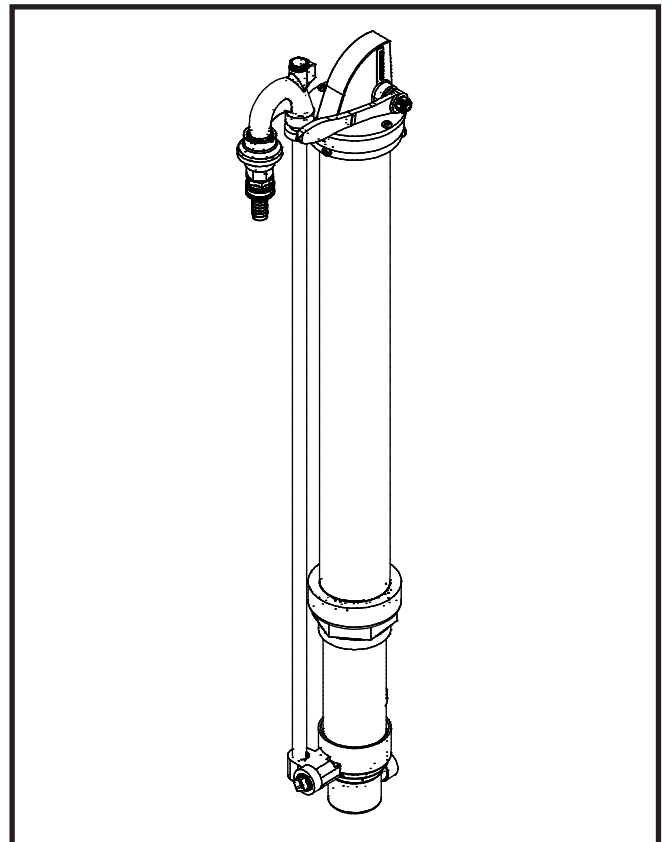

Standard Model: M-EXPELO

#### DEPTH OF BURY *(additional costs may be incurred)*

2 ft. (61 cm)	5 ft. (152.4 cm)
3 ft. (91.4 cm)	6 ft. (182.9 cm)
4 ft. (121.9 cm)	Other _____

WARNING: Cancer and Reproductive Harm - [www.P65Warnings.ca.gov](http://www.P65Warnings.ca.gov)

**MURDOCK MFG.** • 15125 Proctor Avenue • City of Industry, CA 91746 USA  
Phone 800-453-7465 or 626-333-2543 • Fax 626-855-4860 • [www.murdockmfg.com](http://www.murdockmfg.com)

Member of  
 MORRIS GROUP  
INTERNATIONAL

**M-EXPELO**

Revised: 08/21/18



# HYDRANTS

## Post Hydrant

### MODEL M-EXPELO

1" FREEZE RESISTANT, SANITARY  
YARD HYDRANT, HEAVY-DUTY

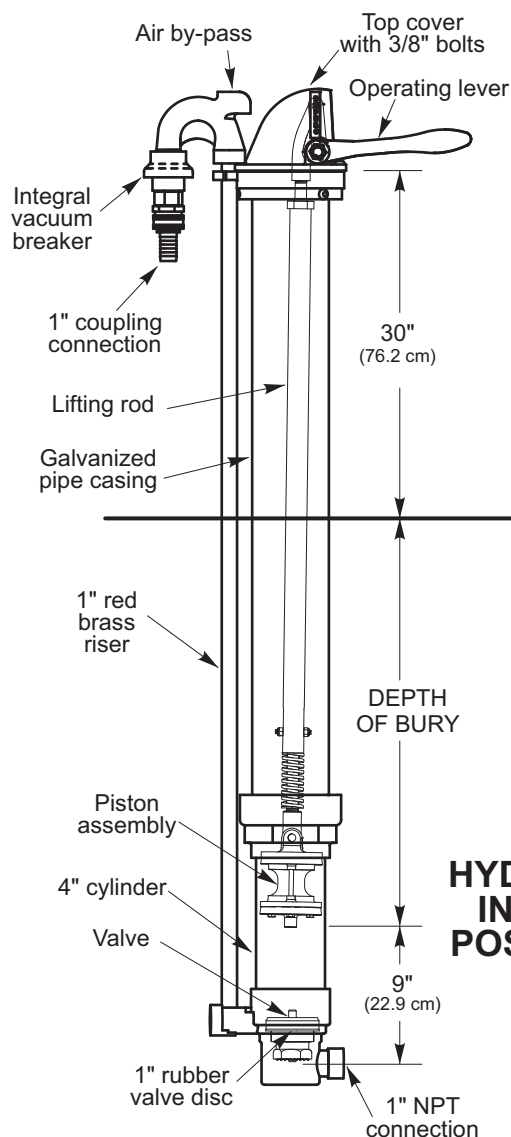

**HYDRANT  
IN OFF  
POSITION**

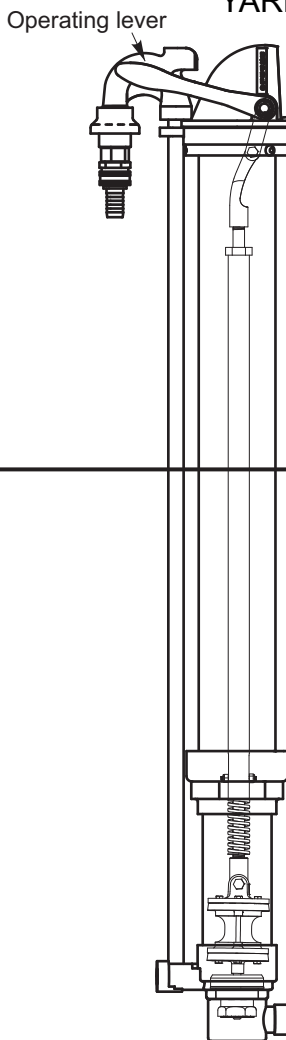

**HYDRANT  
IN ON  
POSITION**

Murdock Mfg.™ warrants that its products are free from defects in material or workmanship under normal use and service for a period of one year from date of shipment. Murdock's liability under this warranty shall be discharged solely by replacement or repair of defective material, provided Murdock™ is notified in writing within one year from date of shipment, F.O.B. Industry, California.

**SELECTION SUMMARY  
& APPROVAL FOR  
MANUFACTURING**

Model Number & Options \_\_\_\_\_ Quantity \_\_\_\_\_

Company \_\_\_\_\_

Contact \_\_\_\_\_ Title \_\_\_\_\_

Signature \_\_\_\_\_ Date \_\_\_\_\_  
(Approval for Manufacturing)

All dimensions are subject to manufactures tolerance of plus or minus 1/2" nominal and subject to change without notice. Murdock assumes no responsibility for use of void or superseded data. Dimensions may change with the addition of optional accessories. Murdock Mfg.™, Member of Morris Group International™. Please visit [www.murdockmfg.com](http://www.murdockmfg.com) for most current specifications.

**MURDOCK MFG.** • 15125 Proctor Avenue • City of Industry, CA 91746 USA  
Phone 800-453-7465 or 626-333-2543 • Fax 626-855-4860 • [www.murdockmfg.com](http://www.murdockmfg.com)

Member of  
**MORRIS GROUP  
INTERNATIONAL**

**M-EXPELO**

Revised: 08/21/18