

ECO-DF Series

ECONOMY MODEL

OUTDOOR PEDESTAL MOUNT
DRINKING FOUNTAIN

STANDARD FEATURES

- Hand Operation is Standard
- Optional Foot Button for Dual Hand/Foot Control
- All Stainless Steel Construction
- Stainless Steel Construction
- 100 Mesh Inlet Strainer

SUGGESTED SPECIFICATIONS

Model ECO-DF Drinking Fountain shall be pushbutton operated requiring less than 5 pounds of force to activate an internally mounted self closing valve. (*Foot Button for dual operation is optionally available.*) Flow rate for Drinking Fountain shall be 0.5 GPM. Drinking Fountain shall include Stainless Steel Drinking Bubbler and Drain Grate. Housing and Pedestal shall be 18 gauge type 304 stainless steel with all exposed surfaces polished to a #4 satin finish. Pedestal base shall include concealed bolt holes for securing unit to floor. Drinking Fountain shall include Drain Grate with 7/8" O.D. flexible waste hose for trench drain waste (below grade). Provide stainless steel Access Panels to service and install unit with vandal-resistant, stainless steel fasteners. Side Access Panel shall include a Cylinder Lock vandal resistance and ease of removal. Unit shall contain a 100 mesh inlet strainer. Unit shall be certified to meet NSF/ANSI 61, Section 9, Public Law 111-380 (No-Lead) and CHSC 116875. Optional WF3000 PFAS Water Filter shall have 3000 gallon capacity with 3rd Party Certification for Lead, Bacteria, Chlorine, Microplastics, and NSF/ANSI for Cyst and total PFAS reduction.



Model ECO-DF

Model ECO-DF-F

MODEL:

(Must Specify)

- | | |
|--|--|
| <input type="checkbox"/> ECO-DF | Pushbutton Operated Drinking Fountain (Standard) |
| <input type="checkbox"/> ECO-DF-F | Foot Button Operated Drinking Fountain
(In addition to Pushbutton Operation) |
| <input type="checkbox"/> ECO-DF-CH33 | Child Height Pushbutton Operated Drinking Fountain |
| <input type="checkbox"/> ECO-DF-CH33-F | Child Height Foot Button Operated Drinking Fountain
(In addition to Pushbutton Operation) |

OPTIONAL ACCESSORIES

(additional costs may be incurred)

- | | |
|----------------------------------|--|
| <input type="checkbox"/> -WF1 | 1500-Gallon Capacity Water Filter ¹ |
| <input type="checkbox"/> -WF3000 | 3000-Gallon PFAS Water Filter ¹
<i>NSF/ANSI, PFAS, Lead, Bacteria, Chlorine, Microplastics</i> |

NOTES:

- 1- Refer to Supplemental Submittal Sheet for Complete Product details.

Complies with the following:



NSF/ANSI/CAN 61

[3000 Gallon PFAS Filter Certifications](#)

[Product Warranty](#)

⚠ WARNING: Cancer and Reproductive Harm - www.P65Warnings.ca.gov

ECO-DF Series
ECONOMY MODEL
OUTDOOR PEDESTAL
DRINKING FOUNTAIN

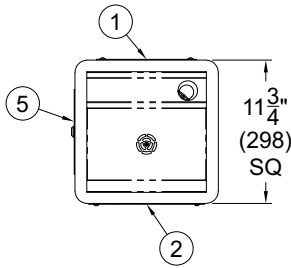

NOTES:

1. REAR ACCESS PANEL
2. BOTTOM ACCESS PANEL
3. DRINKING FOUNTAIN PUSHBUTTON
4. DRINKING BUBBLER
5. SIDE ACCESS PANEL WITH CYLINDER LOCK
6. INSTALLER PROVIDED FLOOR ANCHORS AND ANCHORING HARDWARE
7. OPTIONAL -F FOOT OPERATED BUTTON ASSEMBLY
8. 1-1/4" O.D. WASTE TUBE, BY OTHERS

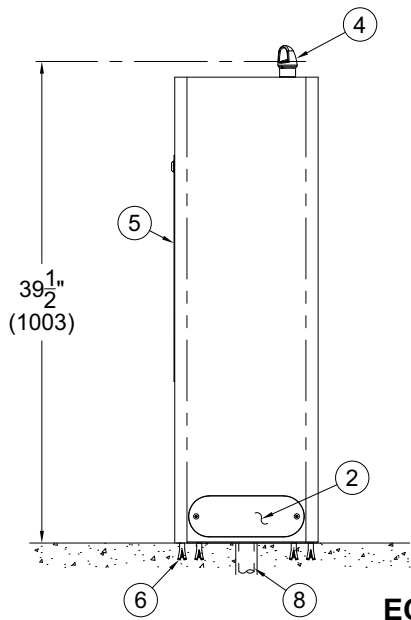

ECO-DF

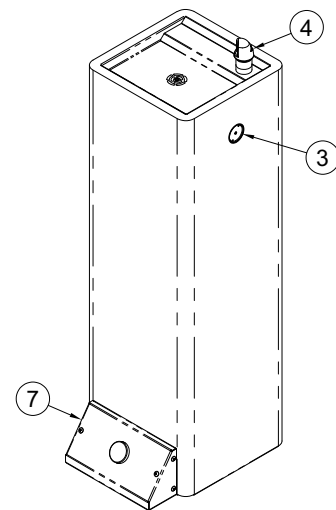
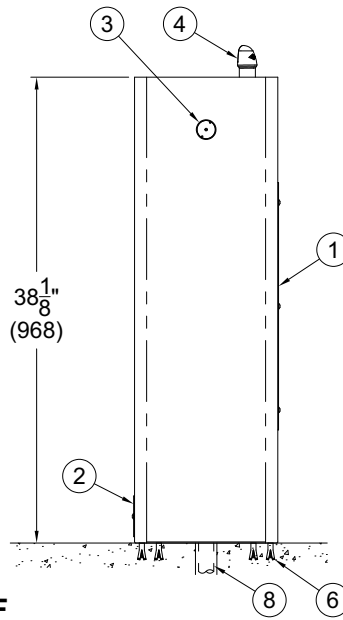

ECO-DF-F

GENERAL NOTES:

1. ALL DIMENSIONS ARE IN INCHES (MM)
2. SUPPLY STOP VALVE NOT PROVIDED

* Valve specifications:
Minimum/Maximum Pressure
30 to 100 psi.

SELECTION SUMMARY & APPROVAL FOR MANUFACTURING

Model Number & Options _____	Quantity _____
Company _____	
Contact _____	Title _____
Signature (Approval for Manufacturing) _____	Date _____

All dimensions are subject to manufactures tolerance of plus or minus 1/4" nominal and subject to change without notice. Murdock[®] assumes no responsibility for use of void or superseded data. Dimensions may change with the addition of optional accessories. Murdock[®] Mfg., Member of Morris Group International[®]. Please visit www.murdockmfg.com for most current specifications.

ECO-DF-CH33 Series

**ECONOMY MODEL
OUTDOOR PEDESTAL
DRINKING FOUNTAIN**

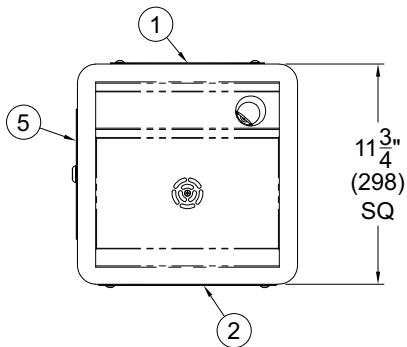

NOTES:

1. REAR ACCESS PANEL
2. BOTTOM ACCESS PANEL
3. DRINKING FOUNTAIN PUSHBUTTON
4. DRINKING BUBBLER
5. SIDE ACCESS PANEL WITH CYLINDER LOCK
6. INSTALLER PROVIDED FLOOR ANCHORS AND ANCHORING HARDWARE
7. OPTIONAL -F FOOT OPERATED BUTTON ASSEMBLY
8. 1-1/4" O.D. WASTE TUBE, BY OTHERS

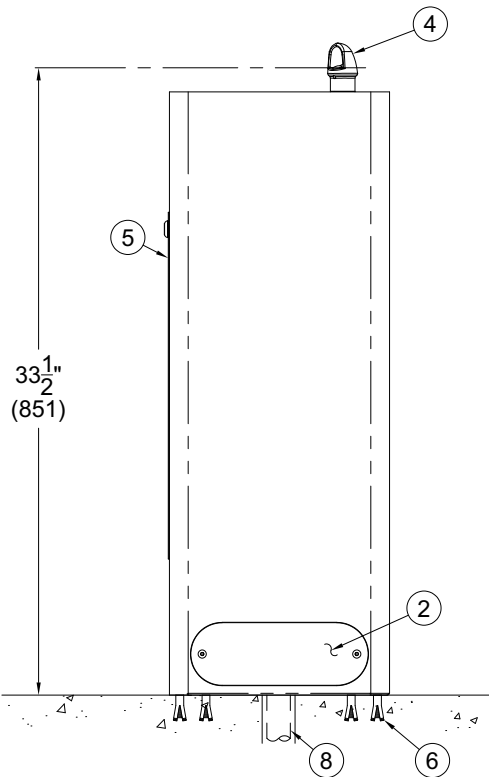

ECO-DF-CH33

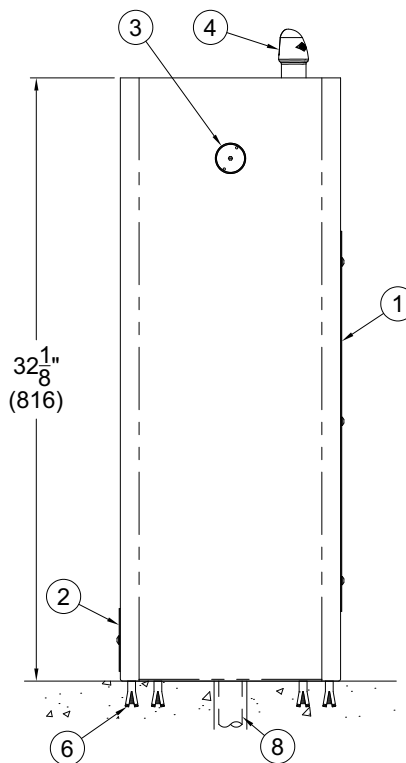

ECO-DF-CH33-F

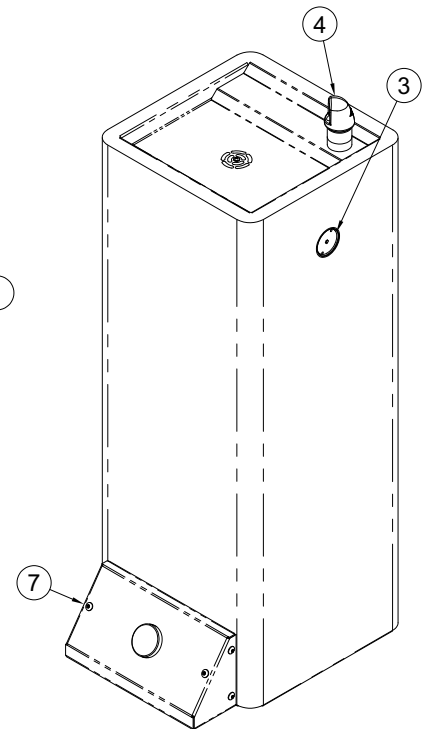

GENERAL NOTES:

1. ALL DIMENSIONS ARE IN INCHES (MM)
2. SUPPLY STOP VALVE NOT PROVIDED

* Valve specifications:
Minimum/Maximum Pressure
30 to 100 psi.