

BF15 Series

SURFACE MOUNT PUSHBUTTON
OPERATED BOTTLE FILLER

STANDARD FEATURES

- 100-Mesh Inlet Strainer
- Laminar Flow Water Supply
- 1.00 GPM Fill Rate
- Lead Free
- Fold Down Housing for easy Maintenance Access
- Universal Mounting Points for easy Retrofit Capability
- ADA Compliant when installed correctly. Refer to 2010 ADA Standards for Accessible Design for complete Installation Requirements particularly if located on an *Accessible Route* or *Circulation Path*. Compliance is subject to the Interpretation and Requirements of the Local Code Authority.

SUGGESTED SPECIFICATIONS

Model BF15 is a Surface Mount Pushbutton Operated Bottle Filler. Bottle Filling unit shall include Pushbutton operated activation. Bottle Filler shall provide approximately 1.00 GPM flow rate with a Laminar Flow Spout to minimize splashing. Housing has a slim and trim look that blends into your environment. Designed for Maintenance Advantage installation and service. Bottle Filler shall provide approximately 1.0 GPM flow rate with a Laminar Flow Spout to minimize splashing. Bottle Filler is fabricated of type 304 stainless steel polished to a satin finish with antimicrobial impact resistant ABS surfaces. Optional WF3000 PFAS Water Filter shall have 3000 gallon capacity with 3rd Party Certification for Lead, Bacteria, Chlorine, Microplastics, and NSF/ANSI for Cyst and total PFAS reduction. When installed properly, the Bottle Filler complies with ADA forward and side reach requirements. Unit shall be certified to Public Law 111-380 (NO-LEAD) and NSF/ANSI/CAN 61. Fixture meets ADA, ADA Standing Person, and ADA Child requirements when mounted appropriately.



"INDOOR USE ONLY"

MODEL:

(Must Specify)

- ☐ -BF15 Surface Mounted Pushbutton Operated Bottle Filler

OPTIONS

(additional costs may be incurred)

- ☐ -LOGO Customer Specified Logo / Graphics
- ☐ -WF3000 3000-gallon PFAS Water Filter¹
NSF/ANSI, PFAS, Lead, Bacteria, Chlorine, Microplastics

NOTES:

1- Refer to Supplemental Submittal Sheet for Complete Product details.

Complies
with the
following
standards:



Federal
Public Law
111-380
(No Lead)



NSF/ANSI/CAN 61

[3000 Gallon PFAS Filter Certifications](#)

[Product Warranty](#)

WARNING: Cancer and Reproductive Harm - www.P65Warnings.ca.gov

MURDOCK MFG. • 15125 Proctor Avenue • City of Industry, CA 91746 USA
Phone 800-453-7465 or 626-333-2543 • www.murdockmfg.com

Member of
MORRIS GROUP
INTERNATIONAL

BF15 Series

SURFACE MOUNTED PUSHBUTTON
OPERATED BOTTLE FILLER

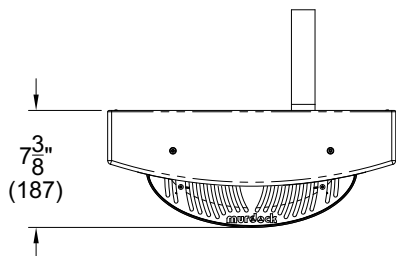

TOP VIEW

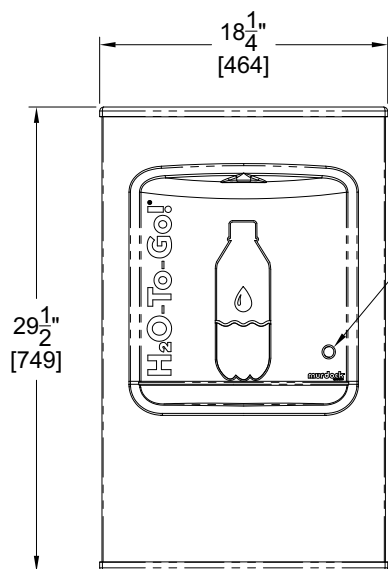

FRONT VIEW

PUSHBUTTON
ACTIVATION

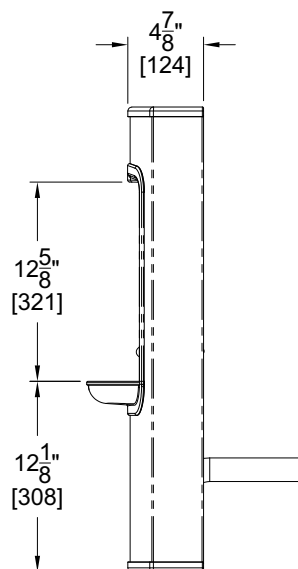

SIDE VIEW

GENERAL NOTES:

1. ALL DIMENSIONS ARE IN INCHES (MM)

SELECTION SUMMARY
& APPROVAL FOR
MANUFACTURING

Model Number & Options _____ Quantity _____

Company _____

Contact _____ Title _____

Signature _____
(Approval for Manufacturing) _____ Date _____

All dimensions are subject to manufacturer's tolerance of plus or minus 1/4" nominal and subject to change without notice. Murdock® assumes no responsibility for use of void or superseded data. Dimensions may change with the addition of optional accessories. Murdock® Mfg., Member of Morris Group International®, Please visit www.murdockmfg.com for most current specifications.